

The perfect fit

FIND YOUR RING SIZE

Make sure to measure the correct finger on the hand you want to wear the ring on. Usually sizes of the left and right hand differ slightly. Note that your fingers may change throughout the day. Finger sizes vary depending on the time of the day and weather (usually they are smaller in the morning and in winter). So measure your fingers at the end of the day when they are warm.

The ring should feel comfortable in a way that you can still move it without fear of losing it.

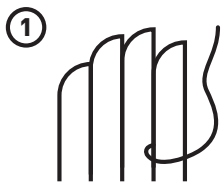

① wrap a string or thin paper around the base of your finger

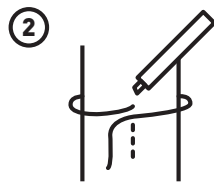

② use a pen to mark the point where the two ends meet

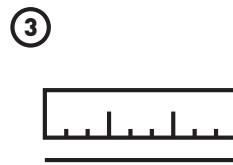

③ measure the string or paper using a ruler (millimetres)

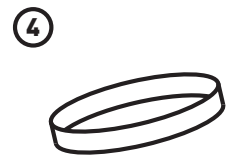

④ your ring size is your measurement in millimetres 😊

If you **already have a ring, that fits you perfectly** but you don't know the size, you can put it on this ring size chart if you print this document on DIN A4 paper (no scaling - actual size) to compare the inside measurement of your ring and choose the closest ring size. If you want to make sure that you printed this document true to size you can check if the following line is exactly 60 mm long: 

Alternatively you can also measure the inner diameter of the ring in millimetres using a tape measure and compare the measurement to the ring size chart.



ring size 49



ring size 50

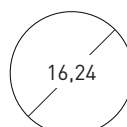

ring size 51



ring size 52

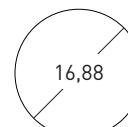

ring size 53

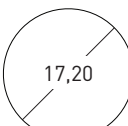

ring size 54



ring size 55

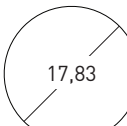

ring size 56

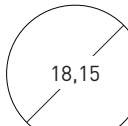

ring size 57

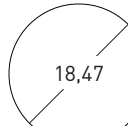

ring size 58

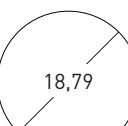

ring size 59

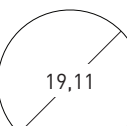

ring size 60

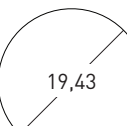

ring size 61

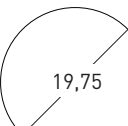

ring size 62

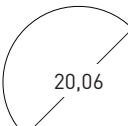

ring size 63



Ring sizes are the inner perimeter of the ring in millimetres. (e.g. ring size 50 = 50 mm perimeter, 15,92 mm diameter)